

PAGE	256	BY	CHK	REVISION RECORD MODIFICATIONS	DATE	REV.
		ALLEN		RELEASE TO PRODUCTION	2007,8,27	1.0

SPECIFICATIONS
 Current Ration: 0.5A AC,DC
 Voltage Ration: 30V AC,DC
 Temperature Range:-25℃ ~ + 85℃
 Contact Resistance:20mΩMax.
 Insulation Resistance:100MΩMin.
 Withstanding Voltage: 200V AC/minute
 Pin Material:Phosphor Bronze/Tin-plated
 Solder Tabs:Phosphor Bronze/Tin-plated
 Material:Nylon 46,UL94V-0
 Cap:Nylon 6T,UL94V-0,Natural(Beige)
 Color:Natural(Beige)

PART NO.	Dimensions	
	A	B
0800MS-02TW-U	0.80	3.80
0800MS-04TW-U	2.40	5.40
0800MS-08TW-U	5.60	8.60
0800MS-10TW-U	7.20	10.20
0800MS-12TW-U	8.80	11.80
0800MS-14TW-U	10.40	13.40
0800MS-15TW-U	11.20	14.20
0800MS-16TW-U	12.00	15.00
0800MS-17TW-U	12.80	15.80
0800MS-20TW-U	15.20	18.20

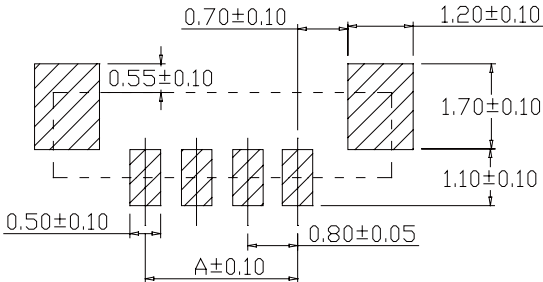
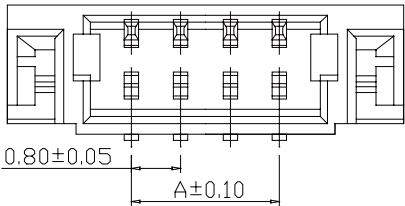

P.C.B. LAYOUT

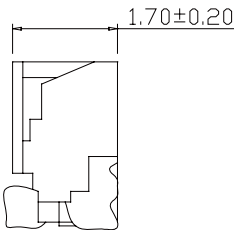
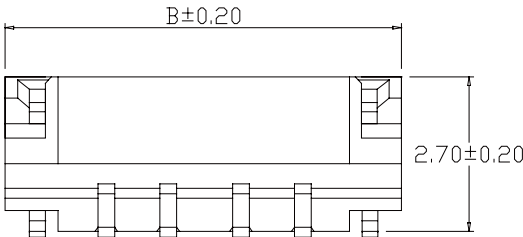

Part No.:0800MS-XXTW-U

APPRO	CHECK	DRAWN	PART NO.	Part No.:0800MS-XXTW-U			DESCRIPTION	
			ITEM NO.					
			DRAW NO.					
			UNIT	mm	SCALE	no		
			TOLER		NO.		Tel:0769 22020068 Fax: 0769 22020069 E-mail: sales@vigortec.com	